

# Kährs®

QUALITY IN WOOD SINCE 1857

## REPAIR GUIDE

---

# CONTENT

**GENERAL RECOMMENDATIONS ON PARTIAL REPAIR PAGE 4**

**REPAIR OF SMALL SURFACE DAMAGES, CRACKS AND DENTS PAGE 6**

**CHANGING OF LAMELLAS PAGE 7**

**GLUING OF UNLOCKED WOODLOC 5S JOINTS PAGE 8**

**REPLACEMENT OF BOARDS PAGE 9**

Replacing boards with Woodloc® joint

Replacing boards with Woodloc 5S® joint

Replacing glued T&G boards

**CLEANING AND MAINTENANCE PRODUCTS – DESCRIPTION PAGE 12**



## SERVICE AND REPAIR OF KÄHRS WOOD FLOORS

To retain the original durability and beautiful appearance, Kährs wood floors should be maintained following a simple regime. This information will be available in the *Kährs Maintenance guide* which can be found on [www.kahrs.com](http://www.kahrs.com)

This guide will give a description of the complete range of service and repair products useful to the professional floor layer. This document will give guidelines and recommendations that will enable a professional floor layer to perform small repairs of indentations, correct unlocked Woodloc 5S® joints and how to change a broken lamella.

We will also inform and guide on how to manage a complete replacement of damaged boards, on a traditional T&G joint, Kährs Woodloc and on the Kährs Woodloc 5S® joint.

## GENERAL RECOMMENDATIONS ON PARTIAL REPAIR – LACQUERED FLOORS

### REPAIRS

#### Partial repairs to multi-layer parquet and Kährs

##### Linnea:

- Treat small surface scratches and scrape-marks with Kährs Lacquer Refresher. On deeper scratches, use Kährs Touch-up Lacquer first.
- Fill small indentations that have cracked the surface with Kährs Touch-up Lacquer. Dirt can collect in the "hollows" on brushed products. Remove dirt from individual areas using a small brush and Kährs Spray Cleaner. Apart from that, look after floors with brushed boards just like other lacquered products. Re-lacquer these floors with Kährs Lacquer. The brushed parts naturally hold more lacquer, and will retain their brushed appearance even after re-lacquering, if somewhat less so. Kährs Lacquer Refresher can be used for maintenance, but the gloss level will gradually increase.
- Fill deep dents, scratches and cracks with Woodfiller or Kährs Hot-Melt Wax in a matching colour, then lacquer with Kährs Touch-up Lacquer. Strips or boards with major damage can be replaced.

### RENOVATION

#### Renovating surface treatment on wood floors:

Microscratches: If small areas of the lacquer have been scratched (by chairs, tables etc.) the floor can be treated with Kährs Lacquer Refresher. This conceals the microscratches. Damp cleaning gradually removes the Lacquer Refresher.

Partial repairs to Kährs multi-layer parquet and Linnea: If a small area is damaged, worn through or needs to be repaired for any other reason, it is best to replace the damaged boards. This is easy with the Woodloc® joint. This applies particularly to stained or special finish boards.

It is important to maintain stained products in good time. Do not allow the stained finish to wear.

#### Renovation with Kährs Lacquer (re-lacquering):

The main reason for re-lacquering is that after many years' use, the floor needs to be "freshened up". The surface to be lacquered must be cleaned thoroughly with Kährs Spray Cleaner. If the floor surface is heavily contaminated, use a rotary floor scrubber (red pad) and Kährs Remover to ensure that the floor is free from grease and dirt. Remove all Kährs Lacquer Refresher using Kährs Remover. Then rub down any residues of Refresher using fine (150 grit) sandpaper or a sanding disc (150 grit) before re-lacquering. During re-lacquering, the temperature in the room and of the lacquer must not be lower than 14°C. The entire floor area must be re-lacquered to prevent the formation of ridges of lacquer. Apply the lacquer using a roller or lacquer brush. When re-lacquering, one coat is enough to cover joints and protect from water.

Remember that the surface to be re-lacquered must not have been treated previously with wax, polish, etc. This prevents adhesion, which would mean that the floor would have to be sanded down to bare wood.

Before re-lacquering, apply lacquer onto a sample area to test adhesion. If the floor has been re-lacquered previously, follow the lacquer manufacturer's instructions. If the floor is likely to be subjected to heavy wear, apply several coats of lacquer.

The floor can be walked on carefully approx. 8 hours after lacquering. Rugs can be laid on the floor one week after lacquering. Be careful with spilt water on the newly lacquered surface during the first week, because this can cause permanent stains. Always follow the instruction for the specific product.

Note that re-lacquering produces a more "plastic" surface appearance than a factory-lacquered floor, and that scratches are more visible because the lacquer used for re-lacquering is less scratch-resistant. Re-lacquering is not carried out in a dust-free environment, so there is a risk that dust particles will adhere to the surface and form little bumps that are visible when the lacquer dries.

#### Total renovation of a wood floor:

If the floor is heavily worn, or needs renovation for some other reason, it can be machine-sanded to bare wood and have a new surface treatment applied.

Note. Kährs Linnea cannot be sanded.

Particular attention must be given to stained products or products with special finishes. Follow the lacquer manufacturer's instructions.

! Underfloor heating must be switched off during re-lacquering.

! When a factory-finished floor that has been glued down using an MS polymer is re-lacquered, the bond between the new coat of lacquer and the factory-finished lacquer cannot be guaranteed.

Note. Any sanding of wood floors includes a risk of delamination of the wood veneers.

This should always be communicated, in writing, to the consumer, prior to starting of the renovation job.

## GENERAL RECOMMENDATIONS ON PARTIAL REPAIR – OILED FLOORS

### RENOVATION

After extended use, it may be necessary to renovate the surface treatment and replace it with a new oil treatment. For very dirty non-stained floors:

1. Clean the floor and make sure that loose particles are removed.
2. Apply the Kährs Satin Oil to the surface and spread out evenly and plentifully using a Yarn Mop.
3. Buff the floor with a green disk pad.
4. Remove any excess oil using a rubber squeegee or cloth.
5. Let the surface rest until the oil has dried (about 30 minutes)
6. Buff the floor with a cloth applied on a white disk pad to remove any excess oil.

Repeat the last step if needed. Please observe that two layers of thin oil gives a better result than one thick layer. Applying a too high amount of oil will result in a sticky surface. After a drying time of 5 hours the floor can be used with care, but needs 12 hours before lighter furniture can be moved back. Wait 24 hours to move back carpets and heavier furniture.

#### Recommended dosage

1 l of Kährs Satin Oil per 40–80 m<sup>2</sup>

### RENOVATION OF FLOORS WITH HEAVY TEXTURE

After extended use, it may be necessary to renovate the surface treatment and replace it with a new oil treatment.

1. Apply Kährs Cleaner evenly over the surface.
2. Clean the surface using a machine with brush (for example Orbot Machine with a brush). Please note, do not use too hard brush. This will prevent damaging of the wood structure.
3. Dry off the surface using an Absorber Pad or a wet vacuum machine. This will remove cleaner and dissolved dirt from the surface.
4. Leave to dry for 30 minutes.
5. Apply Kährs Satin Oil on the surface with a machine (for example Orbot Machine) using white pad (150–180 rpm)
6. Let the surface rest until the oil has dried (about 30 minutes)
7. Apply a second layer of Kährs Satin Oil on the surface with a machine (for example Orbot Machine) using white pad (150–180 rpm)
8. Let the surface rest until the oil has dried (about 30 minutes)

In the case of heavily worn floors, it might be necessary to repeat step 7 and step 8.

9. Buff the surface with a buffing machine (for example Orbot Machine) using white pad (150–180 rpm). This is done to make sure that the oil has been evenly spread.

Please observe that two thin layers of oil give a better result than one thick layer. Applying too much oil will result in a sticky surface.

#### Recommended dosage

1 l of Kährs Satin Oil per 40–80 m<sup>2</sup>

### RENOVATION OF STAINED FLOORS

After extended use, it may be necessary to renovate the surface treatment and replace it with a new Tinted Satin Oil treatment.

1. Apply Kährs Cleaner evenly over the surface.
2. Clean the surface using a machine with brush (for example Orbot Machine with a brush). Please note, do not use an aggressive hard brush. This will prevent damaging of the wood structure.
3. Dry off the surface using an Absorber Pad or a wet vacuum machine. This will remove cleaner and dissolved dirt from the surface.
4. Leave to dry for 30 minutes.
5. Apply Kährs Stained Satin Oil on the surface with a machine (for example Orbot Machine) using white pad (150–180 rpm)
6. Let the surface rest until the oil has dried (about 30 minutes)
7. Apply a second layer of Kährs Stained Satin Oil on the surface with a machine (for example Orbot Machine) using white pad (150–180 rpm)
8. Let the surface rest until the oil has dried (about 30 minutes)

If a stronger recolouring is needed, repeat step 7 and step 8. The amount of Stained Satin Oil layers are maximum 3 times, since too thick layers will result in a sticky surface.

9. Buff the surface with a buffing machine (for example Orbot Machine) using white pad (150–180 rpm). This is done to secure that the oil has been evenly spread.

Please observe that two thin layers of oil give a better result than one thick layer. Applying too much oil will result in a sticky surface.

#### Recommended dosage

1 l of Kährs Satin Oil per 40–80 m<sup>2</sup>

**Note!** A danger of self-ignition exists in contact with organic materials (e.g. cotton cloths, saw dust, absorbing insulation materials etc.) due to self-drying oil content. Rags and other organic materials soaked in oil have to be put into water immediately after use, in order to avoid self-ignition.

## REPAIR OF SMALL SURFACE DAMAGES, CRACKS AND DENTS

In the case of repairing deep dents, scratches and cracks, the edges of the damaged areas must first be cleaned from sharp edges and loose particles. This is done using a scalpel.

In case of repair always follow the instructions on the product packaging.

More information is available on [www.kahrs.com](http://www.kahrs.com).

When repairing dents or similar: you have an option to use putty or Kährs meltable filler sticks.

MINOR SCRATCHES AND SCUFF MARKS

MINOR INDENTATIONS

DEEP DENTS, SCRATCHES AND CRACKS



## CHANGING OF LAMELLAS

### REPLACING STRIPS

#### Only 3-strip products can have strips replaced.

1. The defective strips must be removed without damaging the lacquer edges of the surrounding strips. Therefore, cut through the lacquer layer in the joints around the relevant strip. Use a straight edge and a very sharp knife.
2. Then carefully chisel out the strip using a wood chisel.
3. Cut down approximately 2 mm into the underlying core within the four corners, which will support the new strip. Choose a replacement strip that matches the surrounding strips in colour and wood structure. Factory-treated repair strips can be ordered from us. The new strip must be trimmed to fit the chiselled-out area precisely. Fitting is easier if the bottom edges of the new strip are chamfered. We recommend using a suction cup to lift the strip out when testing the fit. The new strip is fixed in place with a polyester filler, e.g. Plastic Padding. Apply a bead of filler to the middle of the chiselled-out section and around the edges of the underside of the new strip.

Press down the strip so that it is level with the surrounding strips and hold it in place with your fingers until the polyester filler has hardened (approx. 3-4 minutes). Always have a cloth available for quickly cleaning up any surplus filler. After replacing a strip, it may be necessary to apply a small amount of Kährs Woodfiller or Kährs meltable filler sticks in a matching colour around it. Apply Kährs Touch-up where filler has been used. A correctly replaced factory-treated strip is difficult to detect by non-experts.

#### Replacement strips

Kährs can supply replacement strips in all species and surface treatments (and untreated) currently available in its 3-strip range. Strips can of course also be cut from finished boards.



Cut through the lacquer layer in the joints around the strip. Use a straight edge.



Chisel out the strip and 2 mm of the intermediate layer using a wood chisel.



Select and fit a replacement strip. Fill the cavity with polyester filler and press the strip down.

## GLUING OF UNLOCKED WOODLOC 5S JOINTS

In case of an unlocked Woodloc 5S joint, this is a simple way of rectifying the problem.

1. Mark at the tongue side of the board according to picture.
2. Drill 10–12 mm depth into the board. Note, the drilling depth is important, you have to drill in order to reach the cavity (see picture 4).
3. Lift up the board using a suction cup.
4. Inject glue into the drilled holes while continuing lifting the board.
5. Put pressure immediately after injecting glue. Maintain pressure for at least 3 minutes.

Repair the drilled holes using Kährs meltable filler sticks.

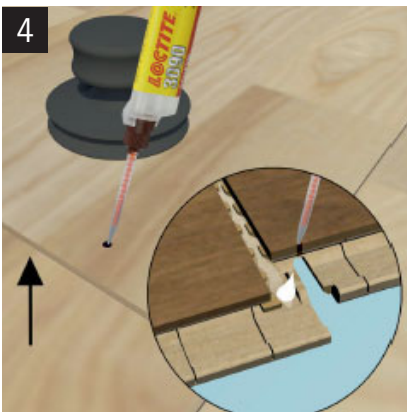
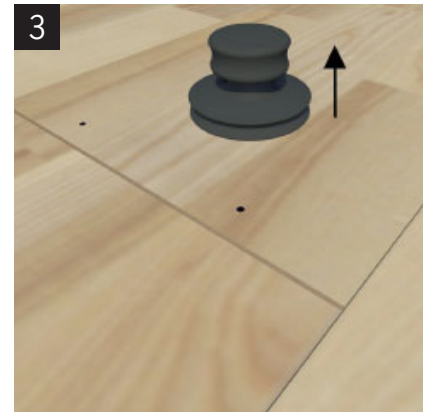
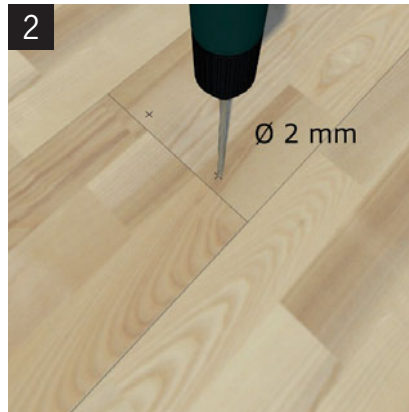
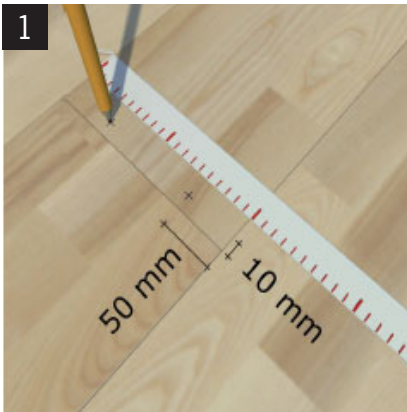

Recommended glue: Loctite 3090



## REPLACEMENT OF BOARDS, WOODLOC

### Replacing boards with Woodloc® joints, option one

The best method is to lift the boards up to the damaged board, replace the damaged board and then re-lay the lifted boards. For best results, re-use a board that was laid near the damaged one, because it will be a similar colour and have comparable wear. Install the new board where its "brand new" colour is less obvious, e.g. near a wall. With the Woodloc® joint, you can lay from the front or the back, and from left to right or vice versa.

### Replacing boards with Woodloc® joints, option two

1. Saw through the damaged board along its centre line. Saw a "V" at each short end.

2-3. Pick out the pieces of old board.

4. Cut away the locking moulding on the underlip on both the long and short sides. Check that the new board fits.

5. Cut off the tongue on the long and short sides. Lightly sand (0,5 mm) the tongue to allow room for the adhesive.

6. Cut the corner on the short side at an angle.

7. Apply Kährs Adhesive to the underlips of the surrounding boards and the replacement board.

8. Tap the new board in place using a Kährs Hand Block, beginning on the long side.

9. Then push the board in sideways. Then tap in the whole of the long side. Place the old board on top of the new one – on the tongue side – and apply pressure while the adhesive dries. The wide contact area for the adhesive makes the joint sufficiently strong.

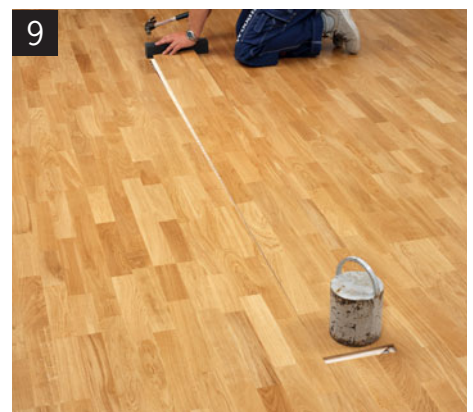
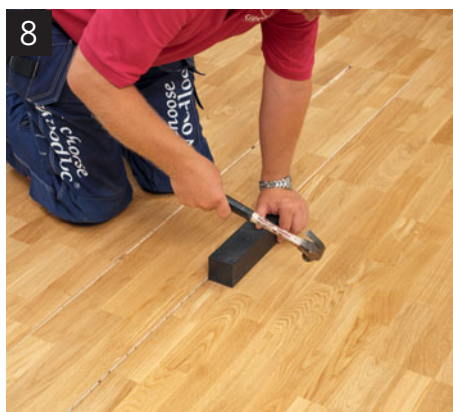
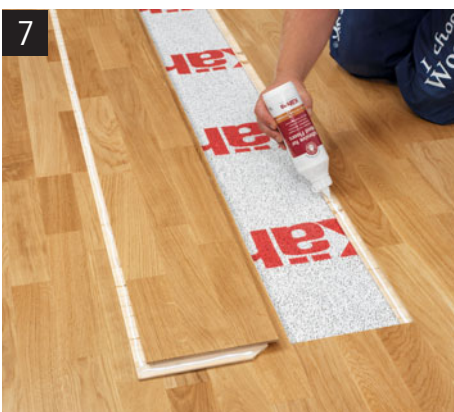
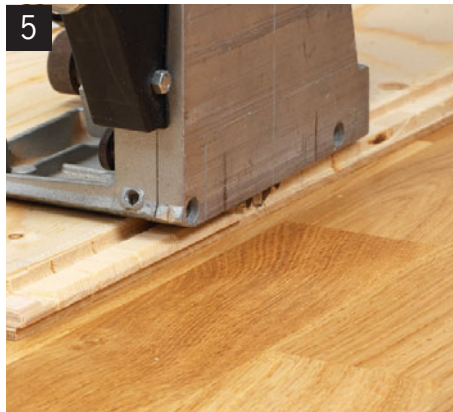
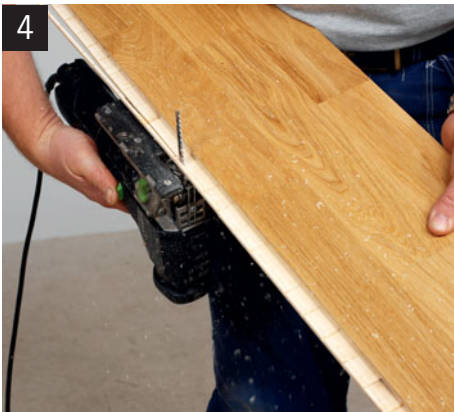

## REPLACEMENT OF BOARDS, WOODLOC 5S

If a board is severely damaged and need replacing, follow the illustrations below.

Replacing boards with Woodloc 5S joints, option two

1. Saw through the damaged board along its centre line. Saw a "V" at each short end.
- 2-4. Pick out the pieces of old board. Use a sharp chisel and make sure you don't damage the adjacent boards.
- 5-6. Cut away the locking moulding on the underlip on both the long and short sides. Check that the new board fits.
7. Cut off the tongue on the long and short sides. Lightly sand (0,5 mm) the tongue to allow room for the adhesive.
8. Cut the corner on the short side at an angle.

9. Apply a new locking pin on the groove side of the new board.

10. Apply Kährs Adhesive to the underlips of the surrounding boards and the replacement board.

- 11-12. Tap the new board in place using a Kährs Hand Block, beginning on the long side. The positioning of the new board will be easier if you apply a weight to the far end of the board. Then push the board in sideways. Then tap in the whole of the long side.

13. Place the old board on top of the new one – on the tongue side – and apply pressure while the adhesive dries. The wide contact area for the adhesive makes the joint sufficiently strong.

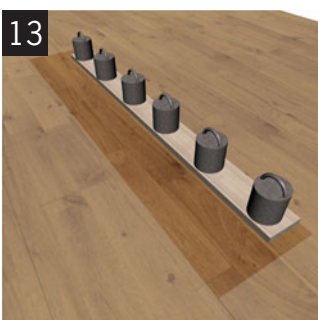
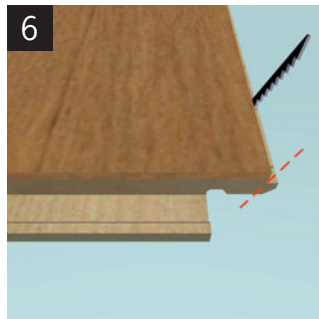
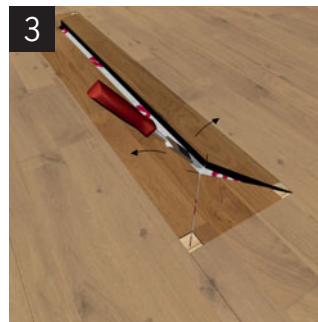
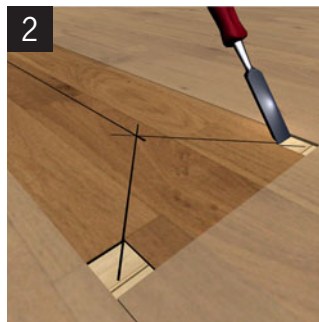
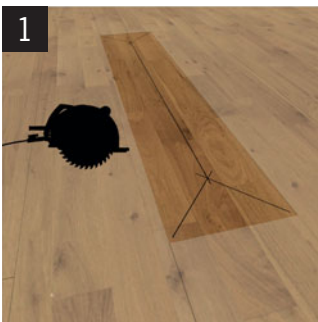

## REPLACEMENT OF BOARD, GLUED T&G

### Replacing tongue and grooved boards

Where there is major damage involving several wear surface strips, one or several boards may need to be replaced as follows: Saw through the damaged board all round, approx. 30 mm from its edge. Lift out the sawn piece and clear the remaining tongue and groove pieces from the surrounding material. It is simple to check with a piece of board that no adhesive residue remains. Check that the new board is the correct length. Cut off the lower section of the groove on both the

long and short sides. After testing the fit and making any necessary adjustments, apply glue to the board and place it in position (see illustration). Place the old board on top of the new one – on the tongue side – and apply pressure while the adhesive dries. Multiple boards can be replaced using the same method.

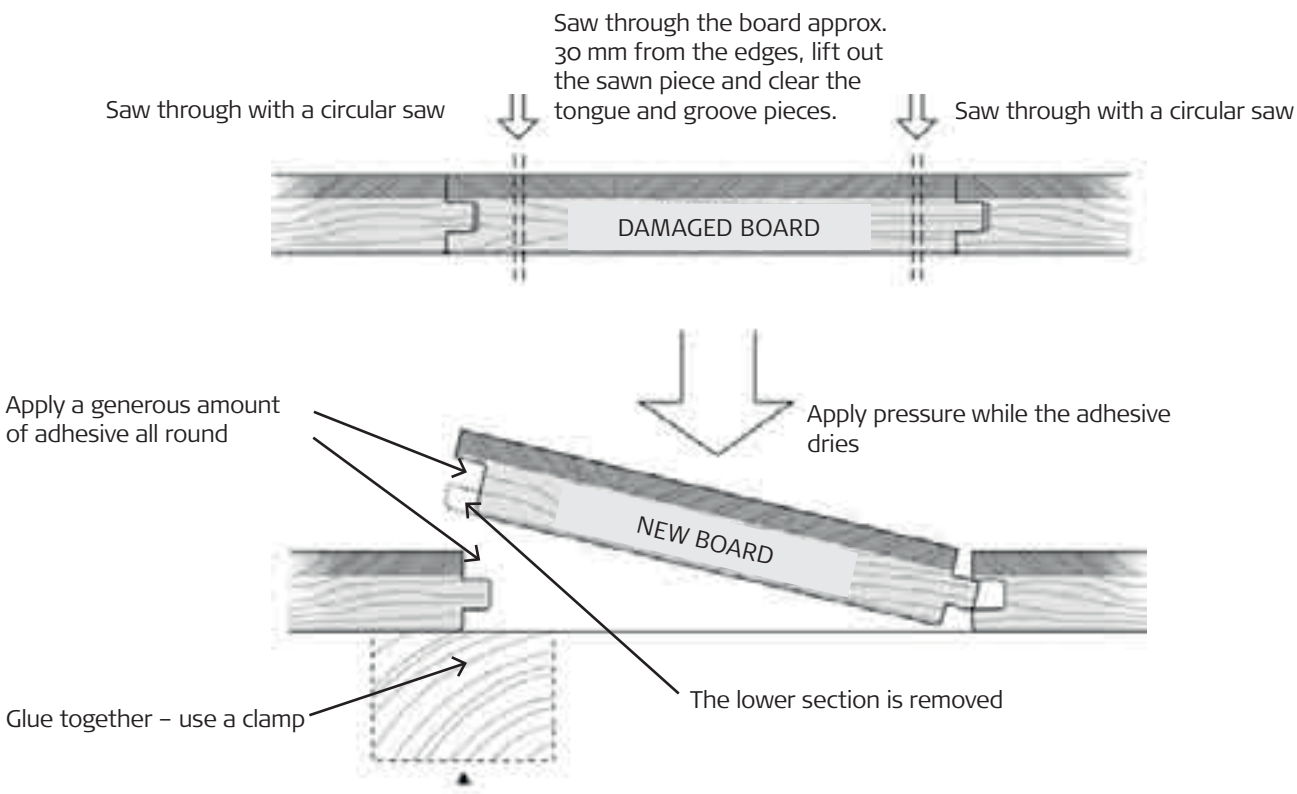

## CLEANING AND MAINTENANCE PRODUCTS – DESCRIPTION

MORE DETAILED INFORMATION ABOUT EACH PRODUCT (TECHNICAL DATA AND APPLICATION INSTRUCTIONS) IS AVAILABLE TO BE DOWNLOADED FROM [WWW.KAHR.S.COM](http://WWW.KAHR.S.COM)

### KÄHRS CLEANER 1,0 LITER

– effective cleaner for lacquered and oiled floors

Kährs Cleaner is an effective and environment friendly product specially formulated for cleaning wood and floors. Does not contain any organic solvents or pigments.

Art no. 710518



### KÄHRS SPRAY CLEANER 0,75 LITER

– effective cleaner for lacquered and oiled floors

Kährs Cleaner is an effective and environment friendly product specially formulated for cleaning wood floors.

Does not contain any organic solvents or pigments. For normal daily cleaning. Ready to use.

Art no. 710529

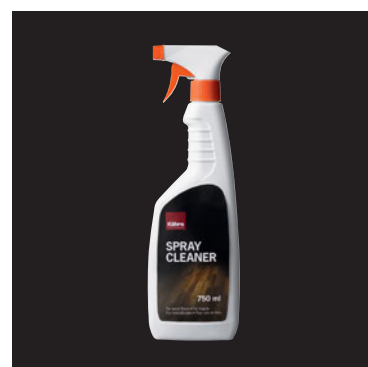

### KÄHRS REMOVER 1,0 LITER

– effective remover of polishes and lacquer refresher

Kährs Remover is a remover for Kährs Lacquer Refresher and Wax based polishes from wooden floors. Kährs Remover can also be used for heavy duty cleaning.

Art no. 710523



### KÄHRS LACQUER REFRESHER 1,0 LITER

– restores finished floors

Kährs Refresher is an easy-to-use refresher for finished parquet and wooden floors. The product gives the wood a protective top surface which simplifies the cleaning and maintenance process.

Art no. 710522



### KÄHRS LACQUER

– floor finish

Kährs Lacquer is a one-component water based polyurethane/ acrylate finish for wood and parquet floors. Suitable for relacquering of satin-lacquered Kährs-floors. Apply with roller, brush or applicator. The finish has excellent durability and is highly resistant to mechanical wear and commonly used household cleaners and detergents. Kährs Lacquer is suitable for residential and commercial use. For Kährs matt lacquered floors or Sport floors use Kährs Matt Lacquer.

Art no. 1,0 liter: 710521

Art no. 5,0 liter: 710519



### KÄHRS MATT LACQUER 1,0 LITER

– floor finish

Kährs Matt Lacquer is a 2-component water based polyurethane finish for wood and parquet floors. Suitable for re-lacquering of matt-lacquered Kährs-floors. Apply with roller, brush or applicator. The finish has excellent durability and is highly resistant to mechanical wear and commonly used household cleaners and detergents. Kährs Matt Lacquer is suitable for domestic and commercial use, as well as Sport floors.

Art no. 710618



### KÄHRS HIGH GLOSS LACQUER 1.0 LITER

– floor finish

Kährs high gloss Lacquer is a 2-component water based polyurethane finish for wood and parquet floors. Suitable for re-lacquering of high gloss-lacquered Kährs-floors. Apply with roller, brush or applicator. The finish has excellent durability and is highly resistant to mechanical wear and commonly used household cleaners and detergents. Kährs high gloss Lacquer is suitable for domestic and commercial use.

Art no. 710630



### SATIN OIL 1 LITER

– clear maintenance oil

Kährs Satin Oil is a hardening urethane oil for maintaining wood and parquet floors. Satin Oil gives the floor a protective oil layer with a beautiful shine. Satin Oil protects by penetrating the floor surface.

Art no. 710553



### STAINED SATIN OIL 1.0 LITER

– tinted maintenance oil

Kährs tinted Satin Oil is a hardening urethane oil for maintaining wood and parquet floors. Satin Oil gives the floor a protective oil layer with a beautiful shine. Satin Oil protects by penetrating the floor surface.

Art no. 710585 Satin Oil Dark-Brown 01, matching for example Romanov

Art no. 710586 Satin Oil Dark-Grey 01, matching for example Ulf

Art no. 710587 Satin Oil Grey-Brown 01, matching for example Sture

Art no. 710588 Satin Oil White 01, matching for example Olof

Art no. 710589 Satin Oil White 02, matching for example Gustaf



### PARQUET POLISH

– restores finished floors

Kährs Parquet Polish is an effective, environment friendly product that revives finished wood and parquet floors. Self-polishing, waterproof and protecting against mechanical wear, Kährs Parkett Polish both cleans and protects your floor.

Art no. 710520



### MATT PARQUET POLISH

– restores finished floors

Kährs Matt Parquet Polish is an effective, environment friendly product that revives finished wood and parquet floors. Self-polishing, waterproof and protecting against mechanical wear, Kährs Matt Parkett Polish both cleans and protects your floor.

Art no. 710539



### SPRAY MOP KIT

Complete cleaning kit for damp mopping of wooden floors. Suitable for both lacquered and oiled floors. Convenient and ergonomic use with trigger controlled cleaner application. The kit includes: Mop holder plate with an ergonomic pole, Replaceable Spray Cleaner tank 0,75 liter, Cleaner Spray 1 liter, 3 pieces of high end washable microfiber mop with Velcro anchoring.

Art no. 710574



### SPRAY MOP CLEANER 0,75 LITER

Refill Package for Spray Mop Kit

Art no. 710576



### KÄHRS FLOOR CARE KIT

The perfect all in one cleaning solution for your Kährs floor. The kit contains a 0.75 litre bottle of Spray Cleaner, a dry mop, and felt floor protectors.



### KÄHRS FLOOR CARE KIT OILED

The perfect all in on cleaning solution for your oiled Kährs floor. The kit contains Satin Oil in a spray mop can (250 ml), a dry mop and felt protectors.

Art no. 710564



### KÄHRS MOP PAD

Replacement pad for your Kährs mop to be used only with Kährs Spray Cleaner. Can be machine washed.

Art no. 710512



### KÄHRS TOUCH-UP

Used for minor repairs to the floor finish. Available for: satin lacquered floors, oiled floors, matt lacquered floors and Oak Brighton, Nouveau White, Nouveau Bronze, Nouveau Black, Nouveau Almond, Nouveau Mocha, Nouveau Brown and Linnea Brown.

Art no. 710223



### KÄHRS WOODFILLER

Used for repairs when the wood has become dented or scratched. For best results use in combination with Kährs Touch-up lacquer.

Ash, Hard Maple Art no. 710619.

Oak Art no.710621.

Beech, Cherry Art no. 710623.

Walnut Art no. 710625.

Black Art no. 710627.

Wenge Art no. 710629

Birch, Pine, Fir Art no. 710620.

Natural Oak Art no. 710622.

Jarrah, Merbau Art no. 710624.

Cherry Art no. 710626.

White Art no. 710628.



## KÄHR'S REPAIR KIT PRO

For repair of damages in oiled, lacquered and stained wooden surfaces. Firstly test on a place, which is not so visible.

Art no. 710517

### Content

- 7x Touch Up Stains
- 1x Touch Up Oil Brown
- 1x Touch Up Oil, stain free oil
- 3x Touch Up Lacquer; semi matte, matte and high gloss
- 11x Hard Wax Bars, different nuances
- 1x Melting Device and Gas Refill
- 1x Scalpel, Scouring Pad and Plastic Spatula
- 10x Flex Pens, different nuances

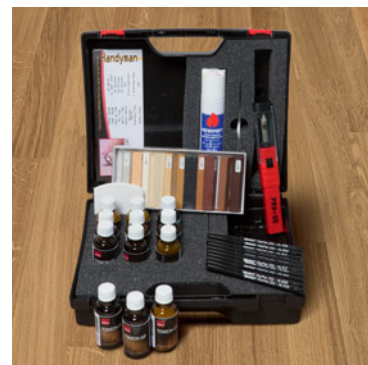

## KÄHR'S REPAIR KIT LACQUERED FLOOR

For the repair of scratches, holes, bruises on parquet, veneer parquet, stairs, doors, furniture

Art no:

Repair kit lacquered floor 710577

Repair kit lacquered floor 5 set 710565

### Content

- 10x Hard Wax sticks (4cm)
- 1x Special Fillers Applicator including Sanding Pad and small Sanding and Polishing Cloth
- 1x Battery Melter incl. 3 batteries
- 1x Sanding and Polishing Cloth
- 1x Cotton Cloth
- 1x Clear Lacquer Brush Pen as sealing pen (sheen level:silk matt)



## REPAIR KIT OILED FLOOR

For the repair of scratches, holes, bruises on parquet, veneer parquet, stairs, doors or furnitures.

Art no:

Repair kit oiled floor 710578

Repair kit oiled floor 5 set 710566

### Content

- 9x Hard Wax sticks (4cm)
- 1x Special Fillers Applicator including Sanding Pad and small Sanding and Polishing Cloth
- 1x Battery Melter incl. 3 batteries
- 2x Sand Paper (grain 150 and 240)
- 1x Special-Oil, 10 ml
- 1x Cotton Cloth
- 1x AQUA Clear Lacquer Brush Pen as sealing pen (sheen level: silk matt)

