



INSTALLATION INSTRUCTION

KÄHRS LUXURY TILES CLICK

GENERAL

The room temperature when installing the floor must be between 64°F - 85°F, and the Relative Humidity in the premises is recommended to be between 25% - 70%. The flooring material must be acclimated in the room for at least 48 hours before installation. The room temperature must be maintained 48 hours before and continuously during and after installation.

If underfloor heating is installed, Kährs LT Click Arcadia may be exposed to max 82°F and the subfloor must be flat and stable.

SUBFLOOR REQUIREMENTS

Kährs Luxury Tiles Click Arcadia can be installed on most substrates, which must be clean, sufficiently dry and firm, free of yield or movement, free of cracks and flat within 1/8" over 6'.

For a concrete substrate, the max. RH is 85% in-situ during installation, measured in accordance with the current industry standard. Any dust or loose particles must be carefully removed. Any stains or spills from paint, oil or similar must be removed. Any unevenness in concrete floors must be levelled. Levelling compound/filler must be sufficiently firm for the area of application in the premises.

In the case of installation on the substrate covered with ceramic tiles, fill the tile joints with the gap wider than 3/16" and deeper than 1/16" with a compound for the filling or a resin grout.

A 6-mil poly film moisture barrier is strongly recommended over concrete subfloors. Failure to use a moisture barrier could affect the integrity of the SPC and installation.

Do not install over carpet, hardwood floors installed directly over concrete or any existing floating floors.

PREPARATION

Kährs Luxury Tiles are suitable for any indoor locations with controlled climate on all grade levels.

Never lean the boxes against the wall when brought to the area for acclimation.

Before starting the installation, make sure you read through the instructions.

IMPORTANT: Check all panels before and during installation for damage or visible defects.

Calculate surface area: Width x Length + 5~10% cutting waste (add 10-20% for Herringbone) and decide on the direction of installation.

Install the flooring along the longest wall or in the direction of the light for the most pleasing visual appeal.

Expansion gap and maximum installation area is:

Kährs LT Click Arcadia and Ranch & Hacienda Collections

Max area 2500 ft², max length or width is 50 ft. Expansion gap 3/8".

The width of the tile on the last row must be no less than 2 inches. If so, adjust the width of the first row. Install the floor as floating, without adhesive.

When fitting under doorjamb, please keep the 3/8" expansion gap. Allow an expansion gap around the whole outer border, i.e. also for pipes, stairs, pillars, door frames and thresholds.

In rooms with quadratic areas (L, F, T, U shapes), we recommend to separate the areas using an expansion joint, especially by door openings.

If you have any questions, please contact your dealer for further information. You can use the floor immediately after installation. The baseboards must be secured to the wall, never to the floor.

MISCELLANEOUS

Color matching between individual tiles can only be guaranteed for tiles with the same production number (see production number on each pack). Always check that all packs have the same production number before installation. Shuffle panels from different boxes to ensure an even distribution of color and pattern. Working out of a minimum of two cartons at a time is recommended.

Even though all material is inspected carefully before delivery, faults can occur. Any deviations (damaged or incorrect floor tiles) must be reported immediately to Kährs and must not be installed but set aside before or during installation. If you are in any doubt before installation, always consult us. Any returns must always be approved by Kährs, so contact us to make sure they are processed correctly.

In conservatories, verandas and winter garden behind large windows or where there is significant light exposure the floor temperature can reach 90°F or more, it is not recommended to install these floors.

Always use pads on furniture to protect the floor against surface damage, scratches, etc.

If construction activity is to continue, place protective covering on newly installed floors. Do not tape the protective cover directly to the floor. The adhesive on the tape can have a negative effect on the floor and some types of adhesive are very difficult to remove.

Office chairs that are to be used on Kährs Luxury Tiles Click Arcadia must be fitted with soft type W castors in accordance with DIN 68131. For higher protection, desk mat can be placed under castor chairs and rolling furniture.

In case you want to replace a damaged plank, cut inside the plank with a cutter and remove the damaged plank. Remove the tongue and groove in each corner of the empty space. Use a hot air blower to make it more flexible, before you install a new plank. Insert first the long side and press it under the groove on the short side. When placed and clicked, just press the tongue in the groove on the other side.

Refer to Kährs LT Guarantee for maintenance and guarantee details.

Please feel free to contact us for additional information. 1-800-800-5247

GENERAL INSTRUCTIONS

LOCKING - PLANK

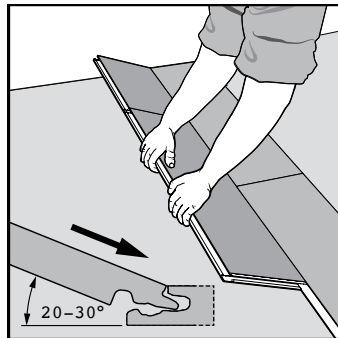
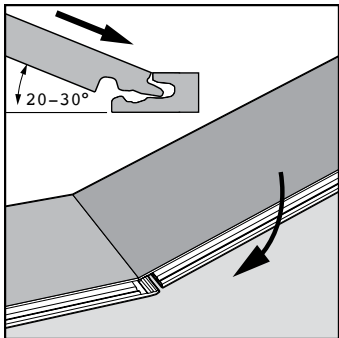

INSTALLATION METHOD A: ANGLE

Start on the short side. Position the panel at an angle of 20-30° to the panel that is already installed, and angle down.

Place your hands close to the joint and move the panel up to an angle of 20-30°. Pull the panel towards the installed panels and angle down.

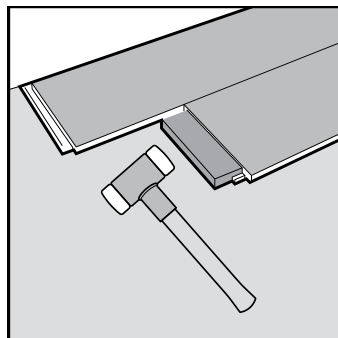
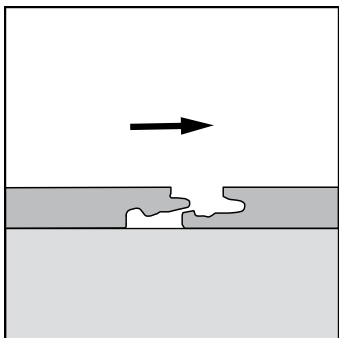

INSTALLATION METHOD B: TAP

For hard to reach panels, use the tapping method. If possible, angle in one of the sides. Angle down and position the click systems as close as possible.

Use a tapping block and position it against the locking system. Gently tap the block with a hammer to gradually connect the panels in a few taps. Use the pull bar instead for the panels against the wall.

GENERAL INSTRUCTIONS

INSTALLATION – ARCADIA, RANCH & HACIENDA PLANK

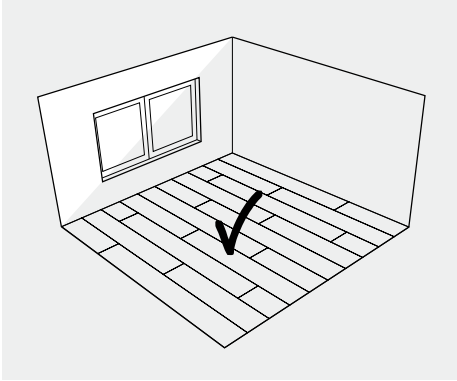

Plan the floor along the longest wall or light direction for the most pleasing visual appeal. Check all panels before and during installation for damage or visible defects.

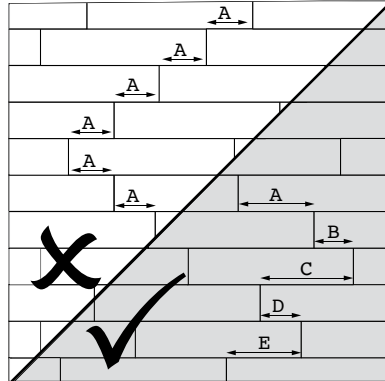

The short ends of tiles in adjacent rows must be staggered by a minimum of 12 inches. Stagger the panels randomly to avoid a staircase pattern and ensure a strong click connection.

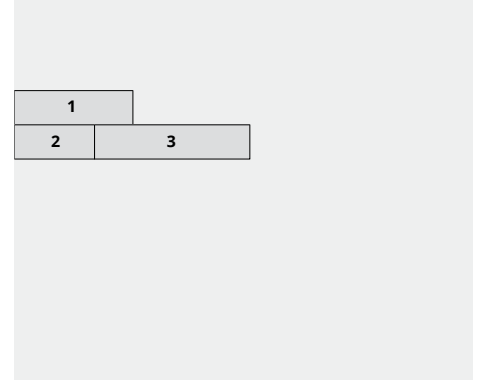

1. Start the first row from the left corner and at a little distance from the wall, with a tongue pointing to the wall. The first panel will serve as a base to install panels two and three.

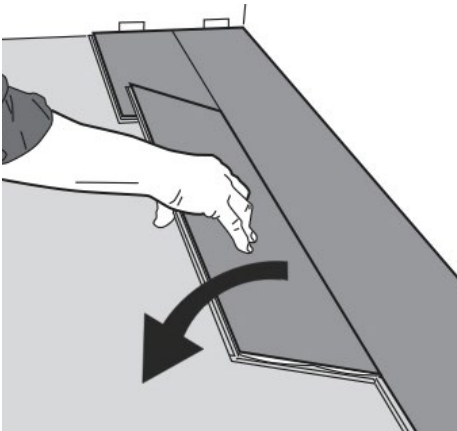

2. Place the tongue of the long side of panel 2 into the groove of the long side of panel 1 at 20-30° and angle down.

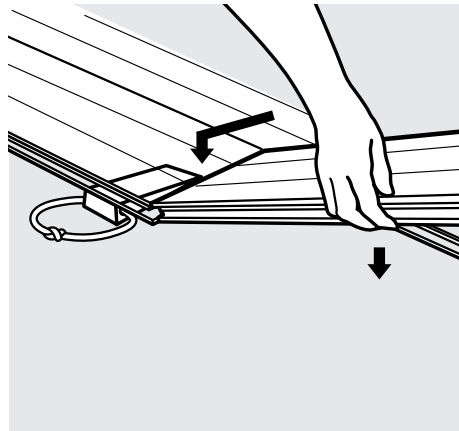

3. Angle in the short side of panel 3 into the short side of panel 2 at 20-30° and angle down.

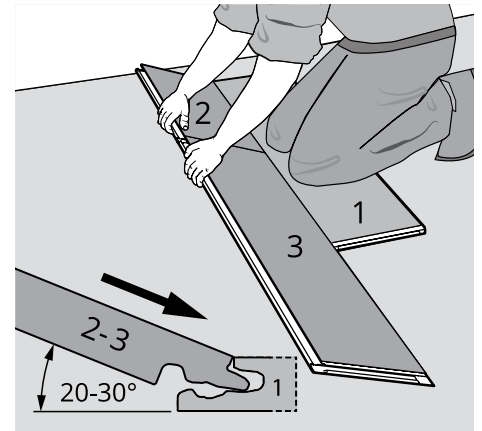

4. Place your hands close to the joint and slide panel 3 towards panel 1. Angle the row of panel 2 and 3 up to an angle of 20-30°. Angle down to completely connect the panels.

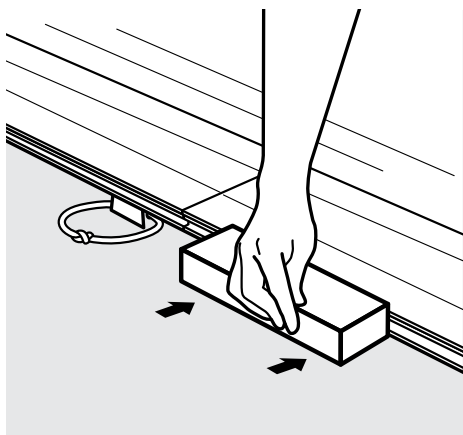

5. After installing a panel, check if all joints are fully connected and there are no gaps or height differences. Tap with the tapping block to completely close the joints.

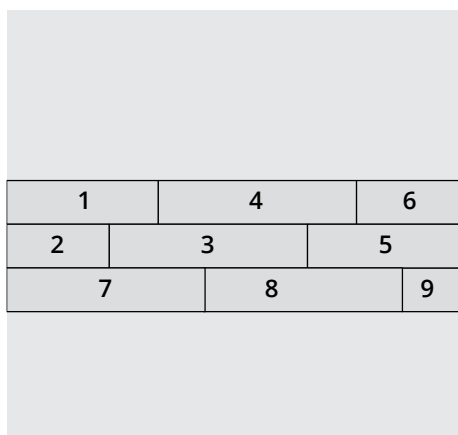

6. Continue installing the rest of the panels for the first three rows in the order of the drawing.

Due to the nature of the LVT floating floor, please always leave a 3/8" expansion gap from the planks to the wall or any fixation.

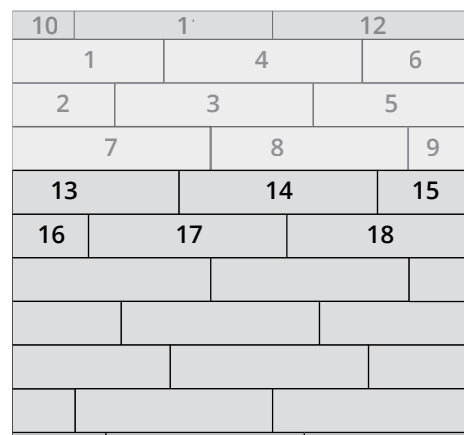

7. Move the rows closer to the wall, leaving a distance equal to the width of the start row plus the expansion gaps.

If the wall is crooked, measure and trim the planks for the first row as needed.

Install the start row by angling in the panels. Use the pull bar and hammer if necessary. Place the spacers to ensure the correct expansion gap.

Continue installing the rest of the panels row by row in the order of the drawing.

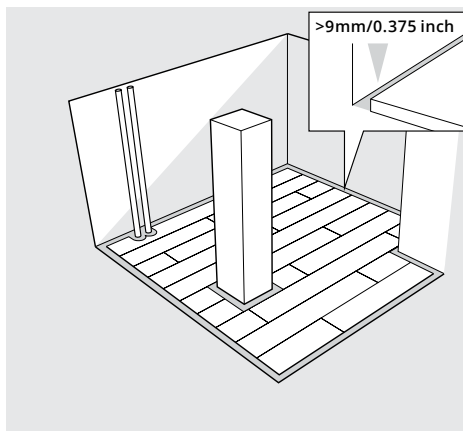

After the floor and expansion profiles are completely installed, remove all spacers from the room(s). Install baseboards or quarter round molding on the walls over the expansion gaps to complete the room.

Always maintain a 3/8" expansion gap from the plank to all vertical fixations in the room: wall, columns, pipes, etc.

Provide expansion joints between different rooms or in large rooms.

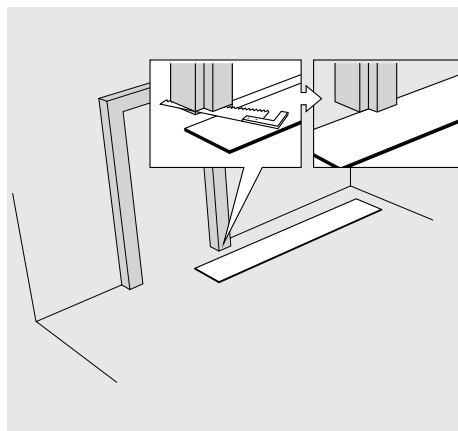

When fitting under doorjamb, please keep in mind the 3/8" expansion gap to allow the floor to float freely. Please avoid cutting the plank along the doorjamb, we recommend you fit it under, so undercut the door jamb and insert the planks.

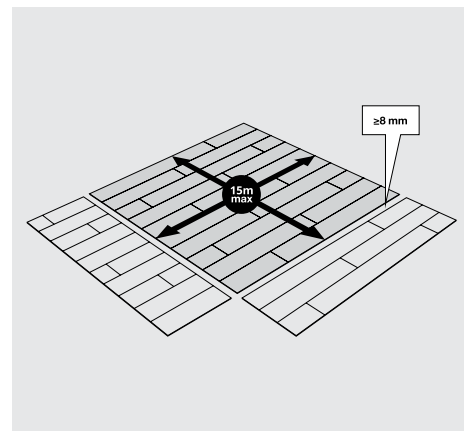

When the connected area's width and length are within 50 feet, the Kährs Luxury Tiles can be laid in one piece. If the measurement exceeds 50' please install suitable dilatation joints to divide the jobsite into smaller installation areas; make sure the width and length of each area is within 50'. Always leave 3/8" expansion gaps from the planks to the dilatation joints.

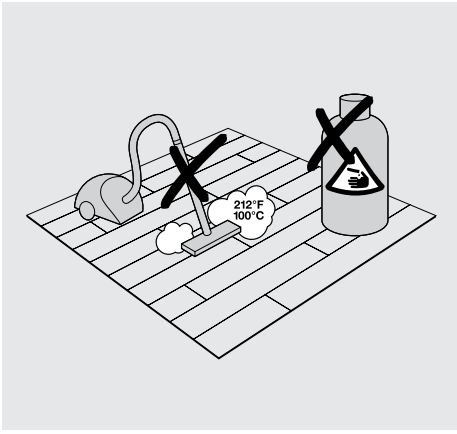

To maintain the optimum condition, please always avoid lasting direct exposure to the sunlight and the indoor temperature should be kept under 90° F.

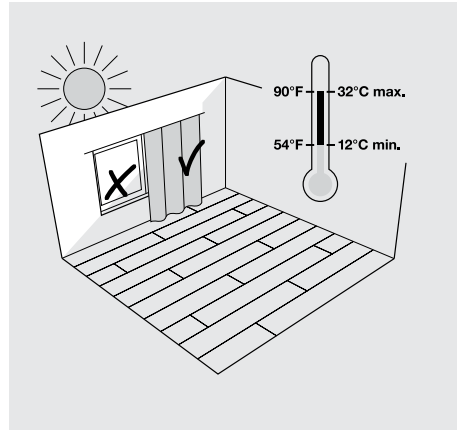

After correct installation, proper cleaning and care are essential.

Please follow the below maintenance and cleaning instruction:

1. The rigid LVT floor is suitable for indoor usage only
2. Do not install in sunroom or conservatory
3. Avoid prolonged exposure to direct sunlight
4. Keep your room temperature constant, and under 90° F
5. Please don't use wax or urethane coating
6. Spots, marks and spillages should be wiped up as soon as possible to avoid staining
7. Clean only with water or mild detergent or residential floor cleaner
8. After cleaning, rinse thoroughly and soak up residual water
9. Never use acetone or chlorinated solvents for cleaning
10. Do not steam clean the floor
11. Remove dust, sand and grit particles frequently by sweeping or vacuuming

GENERAL INSTRUCTIONS

LOCKING - ARCADIA HERRINGBONE

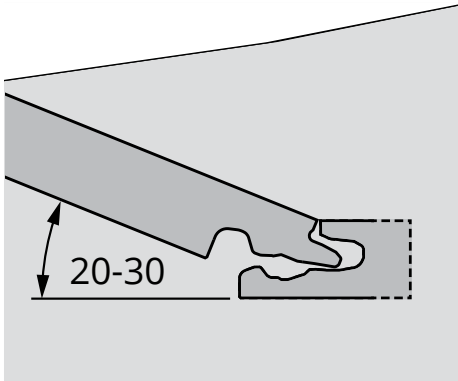

Start on the long side. Position the panel at an angle of 20-30° to the panel that is already installed. Move the panel gently up and down and exert forward pressure.

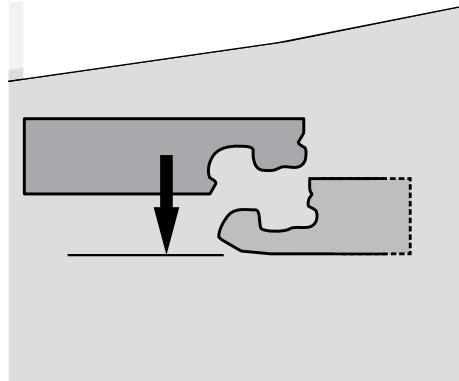

After angling in the long side, drop down the short side of the panel into the short side of the panel that is already installed.

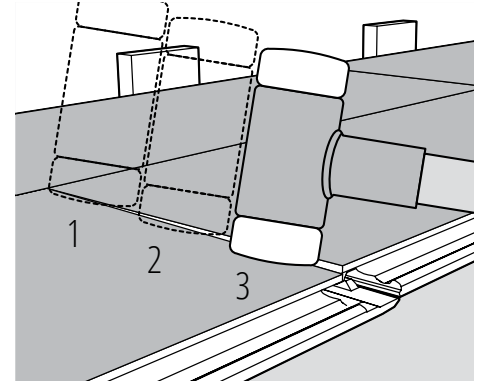

Fully connect the short sides of the panels by hammering from the T joint towards the edge of the panel. Use a tapping block as additional support if necessary.

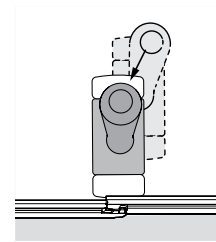

Hammer in the direction of and partly on the underlaying panel. Be careful not to damage the profile or the edges of the panel.

GENERAL INSTRUCTIONS

INSTALLATION - ARCADIA HERRINGBONE

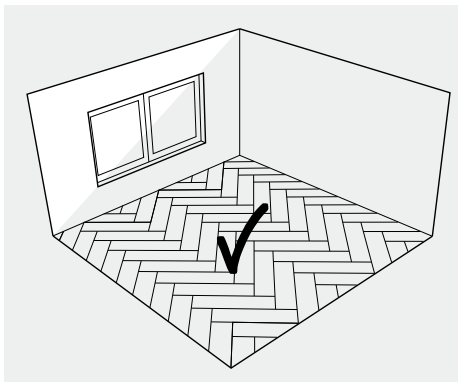

The ideal direction is to be parallel to the main window.

Make sure you have an equal amount of left and right panels. Shuffle panels from different boxes to ensure an even distribution of color and pattern. Inspect the panels for damages.

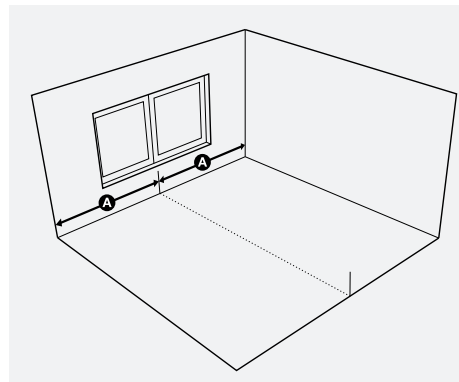

Measure the room before you start installing. Mark the middle of the width of the room on the bottom of the wall.

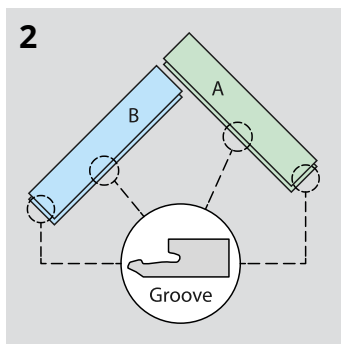
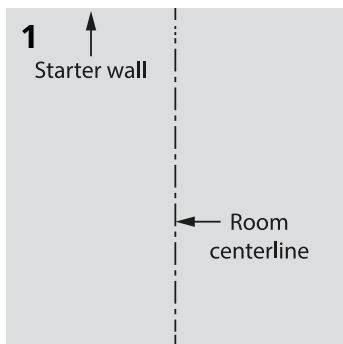

Step 1. Measure the room before you start fitting. Indicate the middle of the width of the room, as shown in figure 1.

Step 2. Make sure that you have an equal amount of A & B types of panels. Later in these instructions the A type panels will be indicated with the letter A, the B type panels will be indicated with letter B.

Tip: During installation, make sure that you mix up the A & B types of panels sufficiently so that there are not too many identical, lighter or darker panels next to each other. Fit an underlay if necessary.

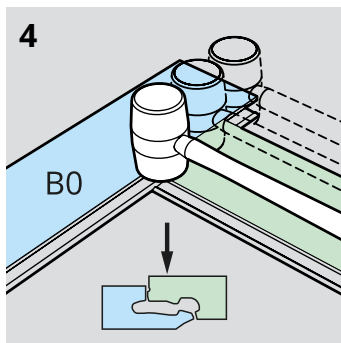
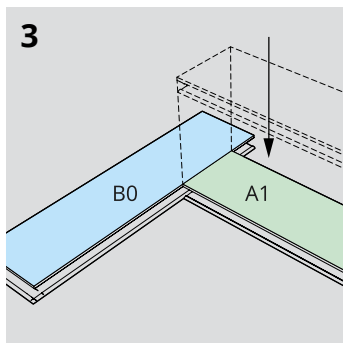

Step 3. Start by positioning the panels in the correct orientation before you install them. Panels (A) and (B) should be positioned with the tongue side facing the starter wall, meaning that the long side groove of both panels (A) and (B) are facing towards you. Panel (B) should be positioned with the tongue on the short side towards panel (A). See figure 2.

Step 4. Position an extra panel (B0) above panel (A1). The purpose of panel (B0) is to ensure correct alignment of the following panels. It will be removed later.

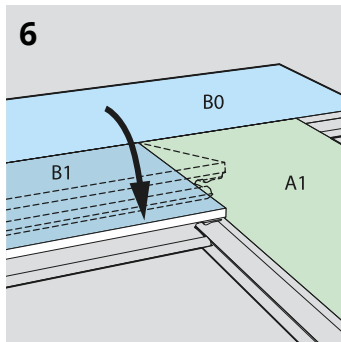
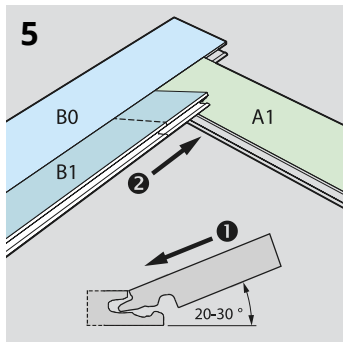

Connect the tongue of the short side of panel (A1) with the groove of the long side of panel (B0) with a drop-down movement, as shown in figure 3. Use a rubber hammer to fully connect the short side of panel (A1). The hammering should be done in the direction of and partly over panel (B0). Please be careful not to damage the profile or edges while engaging the panels. See figures 4 and 5.

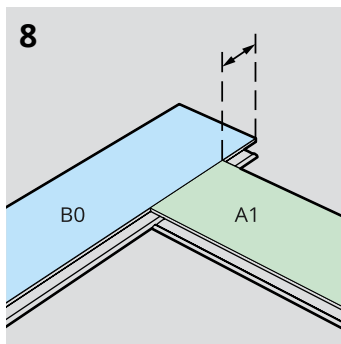
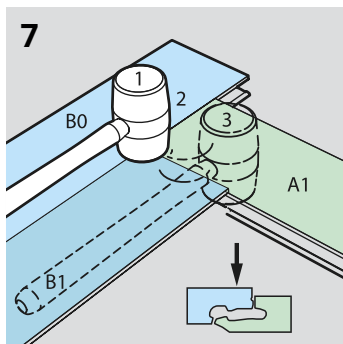

Step 5. The long sides of the panels must be joined by an "angle movement". Insert the tongue of panel (B1) into the groove of panel (B0) at an angle of about 20-30 degrees. Slide panel (B1) until the tongue on the short side is positioned just above the groove of panel (A1), then press panel (B1) down to ensure the long sides of panels (B1) and (B0) are connected.

Finally connect the tongue on the short side of panel (B1) by making use of the rubber hammer, in the same way as described above. See figures 6-8.

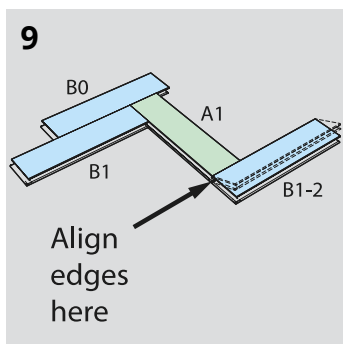

Make sure that the joints are completely engaged over the whole length of the panel. If the angle movement doesn't go easily, it means that the planks aren't correctly engaged with each other.

Step 6. The next step is to connect another (B) panel with the already installed panel (A1) at an "angle movement". Insert the tongue of this panel (B1-2) into the groove of panel (A1) at an angle of about 20-30 degrees and press panel (B1-2) down. See figure 9. Make sure that the edges of the two panels are perfectly aligned with each other.

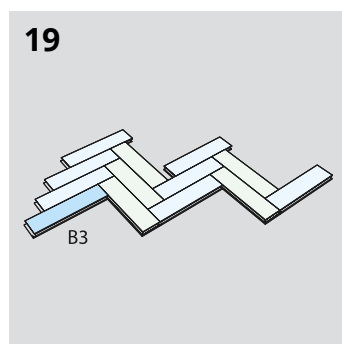
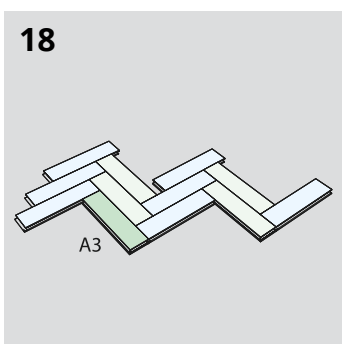
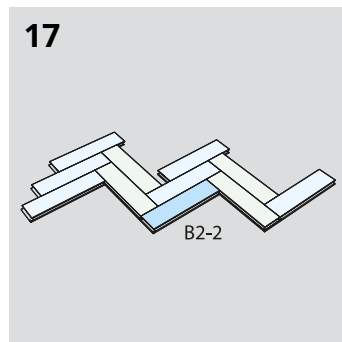
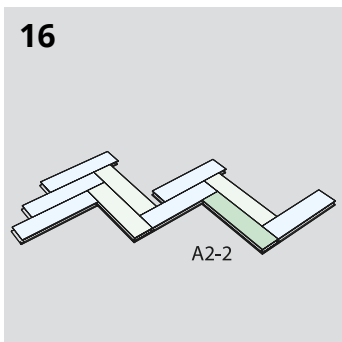
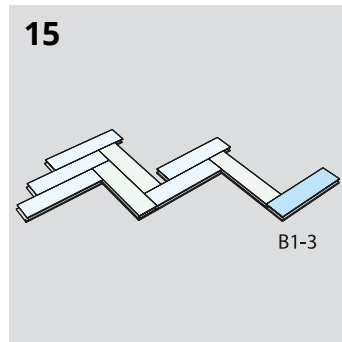
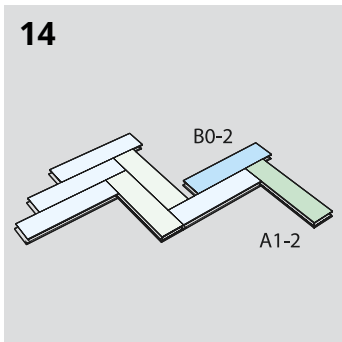
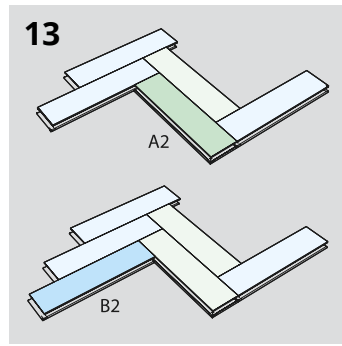
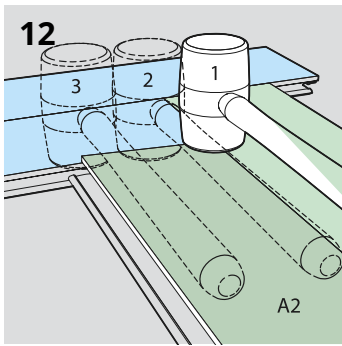
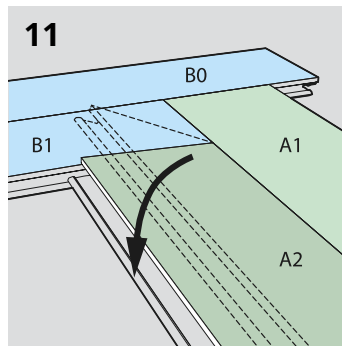
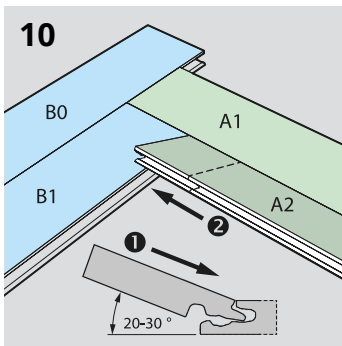

Step 7. Now you can install plank (A2) in the same way as you installed panel (B1). Connect the tongue of the long side of panel (A2) with the groove of the long side of panel (A1) at an angle of about 20-30 degrees. When the long sides are correctly installed, you can connect the tongue of the short side of panel (A2) with a fold-down movement into the groove of the long side of panel (B1). Fully engage these short sides by making use of the rubber hammer, in the same way as described above. See figures 10 - 13. Install the next (B) panel in the first V-row of your floor in the same way. See figure 13.

Tip: It is advisable to sit with your knees or stand with your feet on the already installed panels, to ensure that they don't start shifting during further installation.

Step 8. Follow the above steps 4 - 7 to continue the installation.

1. First you lay a (B0) panel as a temporary supporting panel.

2. Then you can connect the next (A) panel with the supporting (B0-2) panel and already installed (B) panel. The long side groove of panel (A1-2) can be joined with the short side tongue of the (B) panel by an angle movement. When the long side of panel (A1-2) is correctly installed, you can connect the tongue of the short side of panel (A1-2) with a fold-down movement into the groove of the long side of the supporting (B0-2) panel. Fully engage both the short side of the (B0-2) panel and the short side of panel (A1-2) by making use of the rubber hammer, in the same way as described above. See figure 14.

3. The next step is to connect the long side tongue of the next (B) panel to the short side groove of the newly installed (A) panel, by making use of an angle movement. See figure 15. Always ensure that the edges of the two panels are perfectly aligned with each other.

4. Now that you have created the next 'V-row', you can install the following 4 panels of this and the previous 'V-row'. Always connect the long side tongue of the panels to the long side groove of the adjacent panels by making use of an angle movement. Afterwards, connect the tongue on the short side of the panels to the groove of the long side of the adjacent panels with a fold-down movement. See figures 16 - 19.

5. After installing these panels, you can start creating the next 'V-row' with a new supporting (B)panel and follow then repeat the above steps. It is very important to make sure the rows are perfectly centered in the middle of the room. Please take a moment to verify this.

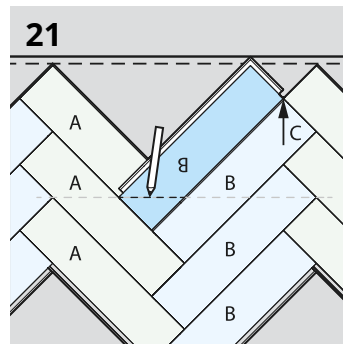
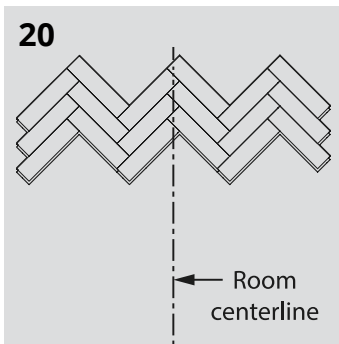

Step 9. After having installed about 5 full V-rows, you can take away the supporting (B) panels and move the rows up to the starter wall, as shown in figure 20. Don't forget to take into account an expansion gap between the wall and the panels.

Step 10. The open triangles between the starter wall and the installed V-rows still need to be installed.

These panels need to be cut off at the correct angle. To draw the cut-off line, rotate the panel by 180° and place it on the floor in its intended position, but with its corner aligned with the corner of the adjacent board, as indicated in figure 21 by the arrow and the letter "C". The dashed grey line in figure 21 shows that if the cut-off line was extended, it would intersect the corners of the nearby panels. The projecting grooves of the rotated panel will overlap the expansion gap while the cut-off is being marked. This expansion gap is needed to allow the floor to move naturally after installation. The marked panel can now be sawn. Insert the long sides of the cut-off panels at an angle of about 20-30 degrees. Press the panels down to ensure these long sides are fully connected. Finally connect the short sides of the panels by a snapping movement.

Use the tapping block and rubber hammer for this. Place the tapping block against the opposite short side of the panel and gently tap until the short sides of the panels are fully connected.

Tip: It is advisable to sit with your knees or stand with your feet on the already installed panels, to ensure that these panels don't start shifting during installation. Check after tapping panels into place that they are still well connected and perfectly aligned.

Step 11. After installing all rows of full planks, the last step in the installation of the herringbone floor is the installation of the cut-off planks along the side walls of your room. To draw the cut-off line, rotate the panel by 180° and place it on the floor in its intended position. The corner "C" must be on the line of the expansion gap. Draw the line parallel with the wall, at the point where the rotated panel intersects the already installed panel (the position of the pencil in figure 23). Now you can saw the panels.

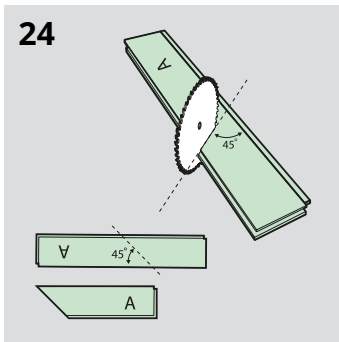
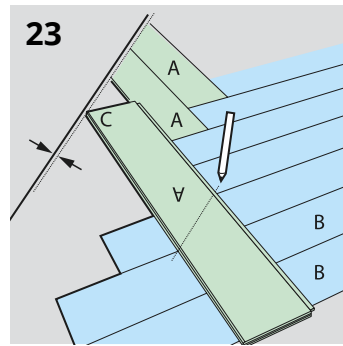
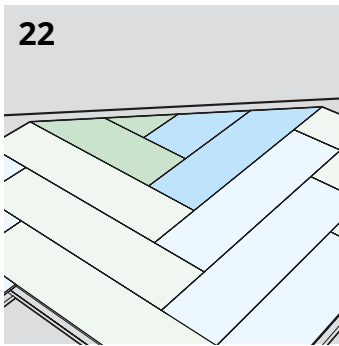

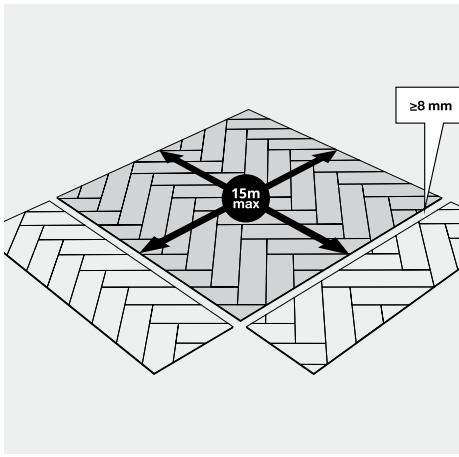

When the jobsite's width and length are within 50 feet, the Herringbone CLICK vinyl floor can be laid in one piece. If the measurement exceeds 50', please install suitable dilatation joints to divide the jobsite into smaller installation areas; make sure the width and length of each area is within 50'. Always leave 3/8" expansion gaps from the planks to the dilatation joints.

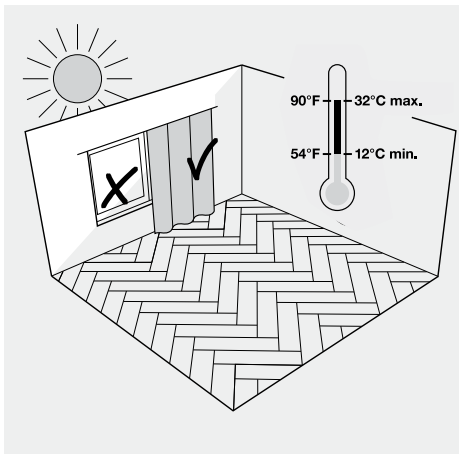

To maintain the optimum condition, please always avoid lasting direct exposure to the sunlight and the indoor temperature should be kept under 90°F

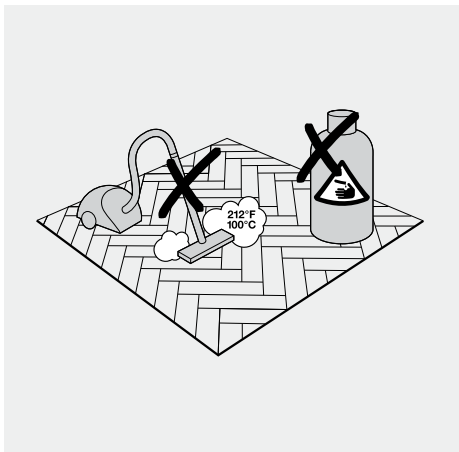

After correct installation, proper cleaning and care are essential.

Please follow the below maintenance and cleaning instruction:

1. The rigid Herringbone floor is suitable for indoor usage only
2. Do not apply on area of sunroom or conservatory
3. Avoid prolonged exposure to direct sunlight
4. Keep you room temperature constant, and below 90°F
5. Please don't use wax or urethane coating
6. Spots, marks and spillages should be wiped up as soon as possible to avoid staining
7. Clean only with water or mild detergent or residential floor cleaner
8. After cleaning, rinse thoroughly and soak up residual water
9. Never use acetone or chlorinated solvents for cleaning
10. Do not steam clean the floor
11. Remove dust, sand and grit particles frequently by sweeping or vacuuming